

Mission: Kala Soudha Global University for all Performing Arts

Kala Sourabha Academy [Educational & Training division of Kala Sourabha Foundation]

Objectives and activities in Kala Soudha

- * Patronage center for performing artists
- * Sharing humanity through arts
- * Free training to economically weaker section of the society
- * Creating an opportunity for the special children
- * Creating wide opportunities to the ALL artists
- * Opportunities to the talents of rural sector through various competitions & training program

Activities: 1. Training & Education

- Training with the blend of modern & traditional system of Gurukula
- 3 / 6 months certificate courses
- 2/3 years of academic/professional courses
- Training center for learning World Art & Culture
- Training with residential facilities
- Workshops / seminars

2. Shows, Events & Competitions

- Cultural Festivals / fairs
- Musical symphony / Art Exhibitions

3. National & International events

- Training/Workshops/Seminars/Conventions
- Interstate/International Cultural exchange hub

4. Library, Art Gallery & Museum

- World class museum for All types of musical instruments
- Huge multilingual library to study Art & Culture of world



Monument will be established *in the shape of* **RudraVeena:**

| | |
|----------------|--|
| Area | : 10 acres of land |
| Basement | : 400 ft X 200 ft (approx. 2 acres) |
| Floors | : 4 main: 4 Mezzanine floor in each dome |
| Open gallery | : 9th Floor |
| TOP connecting | |
| Structure | : 10th Floor |
| Built Area | : Approx. 175000 sq. ft. |
| Surrounded | : by Residential Kutiras |

Kala Soudha consists of:

| | |
|---------------------|--|
| Classrooms | : 10 for each departments Music-Arts-Dance |
| Counseling | : 1 in each floor |
| Discussion hall | : 1 in each floor |
| Auditoriums | : 4 (Mini - Small - Medium - Big) |
| Basic amenities | : In all the floors |
| Museum | : Exclusive Instrumental museum |
| Library | : Exclusive Library space |
| Exhibition Gallery: | 4 numbers |
| Meditation hall | : 2 numbers for meditation / yoga |
| Pantry | : Huge kitchen with a food distribution hall |

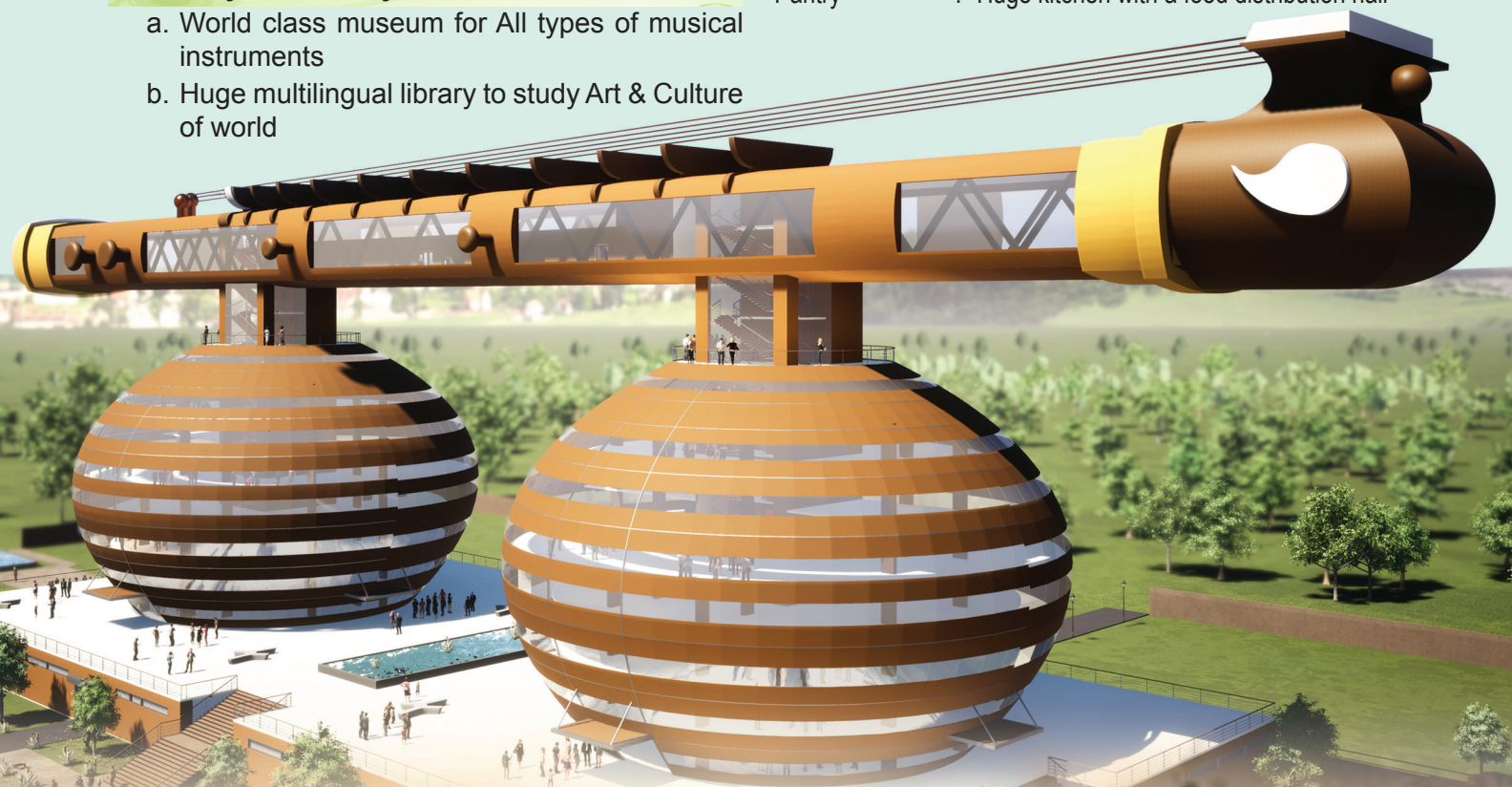

R C Nathan
CEO

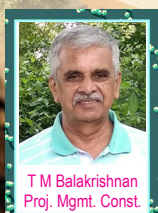

T M Balakrishnan
Proj. Mgmt. Const.

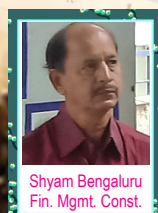

Shyam Bengaluru
Fin. Mgmt. Const.



C Nagesh
Joint Secretary



Asok Putiyan
Chief Architect

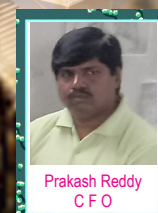

Prakash Reddy
CFO



CS Padmakumar
CMO

Mission: KalaSoudha team